

INSTRUMENT PANEL ASSEMBLY

< ON-VEHICLE REPAIR >

ON-VEHICLE REPAIR

INSTRUMENT PANEL ASSEMBLY

Exploded View

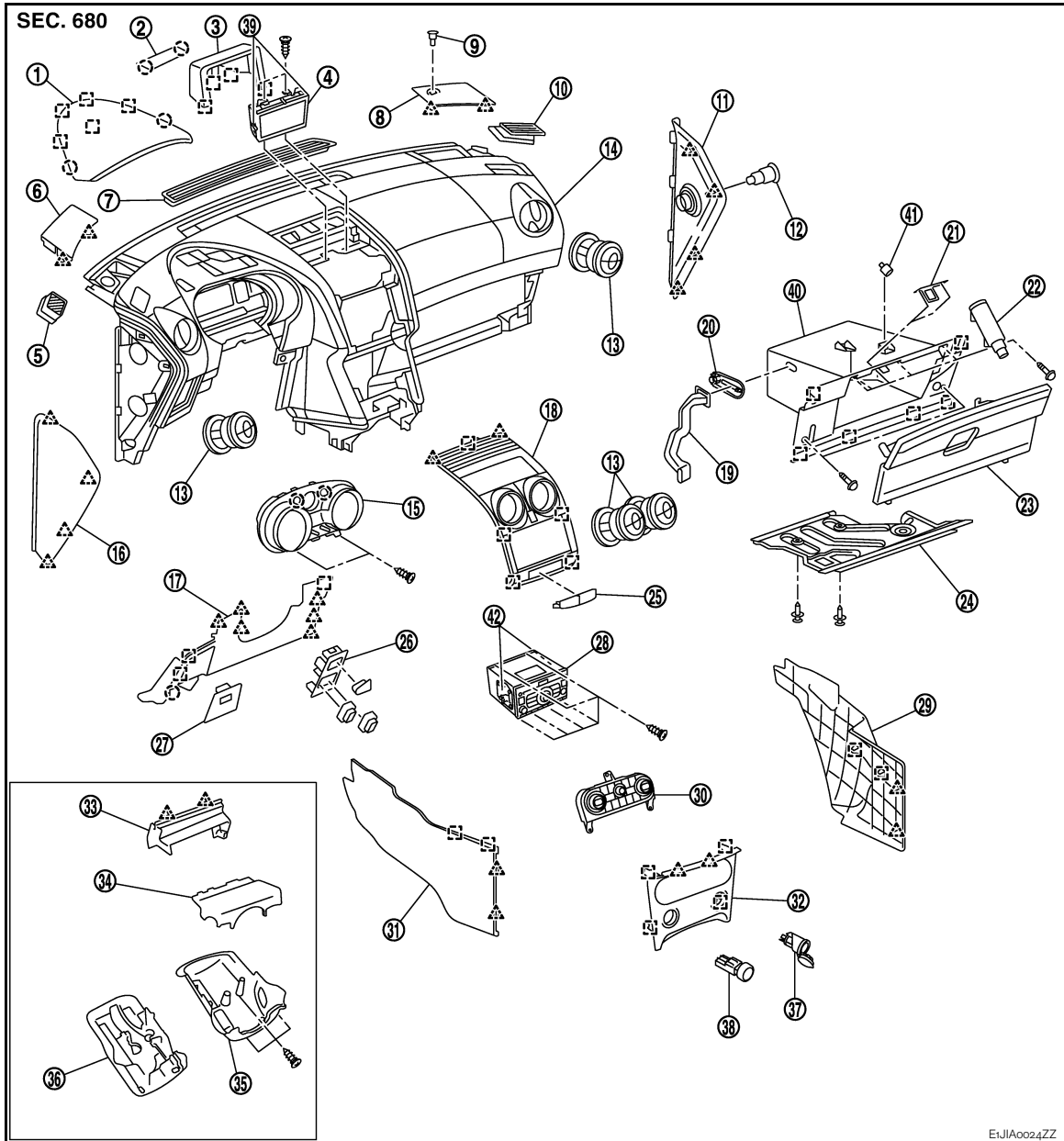

INFOID:000000001183494



- | | | |
|---|--|--|
| 1. Cluster lid A | 2. Display unit cover finisher | 3. Display unit cover |
| 4. Display unit | 5. Defroster grille (LH) | 6. Tweeter grille (LH) |
| 7. Front defroster grille, center | 8. Tweeter grille (RH) | 9. Sunload sensor (if equipped) |
| 10. Defroster grille (RH) | 11. Instrument side finisher, passenger side | 12. Passenger airbag cut-off switch assembly |
| 13. Ventilation grille | 14. Instrument panel assembly | 15. Combimeter assembly |
| 16. Instrument side finisher, driver side | 17. Lower instrument panel, driver side | 18. Cluster lid C |
| 19. Glove box air duct | 20. Glove box air duct opener | 21. Glove box striker |
| 22. Glove box door damper | 23. Glove box door | 24. Lower instrument panel, passenger side |

INSTRUMENT PANEL ASSEMBLY

< ON-VEHICLE REPAIR >

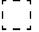
- | | | |
|--|--|--|
| 25. SRS information display | 26. Mirror/ESP/headlamp level switch holder | 27. Fuse box lid |
| 28. AV/navigation unit assembly | 29. Lower instrument cover, RH | 30. Air conditioner controller |
| 31. Lower instrument cover, LH | 32. Cluster lid D | 33. Steering column upper soft cover |
| 34. Steering column upper cover | 35. Steering column lower cover | 36. Steering column protector |
| 37. Power socket | 38. Ventilation button | 39. RH/LH NAVI display brackets |
| 40. Cover glove box | 41. Glove box bulb | 42. Audio brackets |
|  Clip |  Pawl |  Metal clip |

Removal and Installation

INFOID:000000001183495

REMOVAL

- Put selector lever in drive position. (AT and CVT Models)
- Remove center console front fixing screws and clip.
- Remove cup holder.
 - Pull upward to release cup holder pawls from center console assembly.
- Release switch panel (A) from center console assembly as shown.
 - Disconnect harness connectors. Refer to [DLK-279, "Exploded View"](#)
 - Remove switch panel

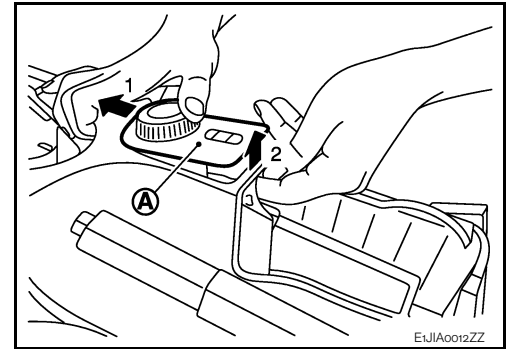

- Remove front console finisher from underside of switch console.

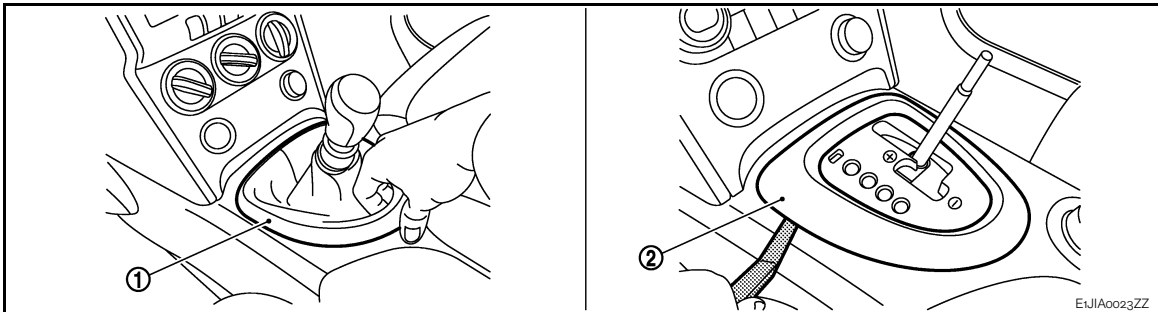

- Front console finisher (MT models)
- Front console finisher (AT and CVT models)

- Remove Cluster lid D.
 - Using clip remover or other suitable tool, release cluster lid metal clips, from lower to upper, from Instrument Panel.
 - Release harness connector.

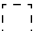
-  Clip
 : Metal clip

CAUTION:

Special care required as part has soft feel paint applied. Screw driver (wrapped in cloth to prevent scratching) should be used.

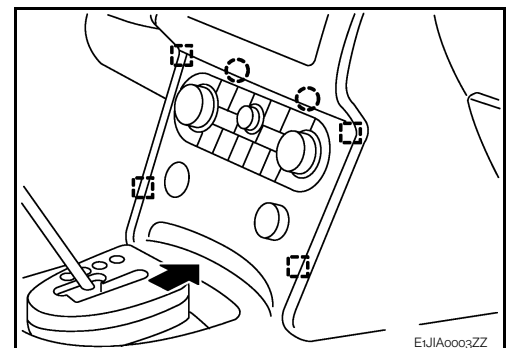

INSTRUMENT PANEL ASSEMBLY

< ON-VEHICLE REPAIR >

7. Remove screws (B) of center console front side with screw driver (A).

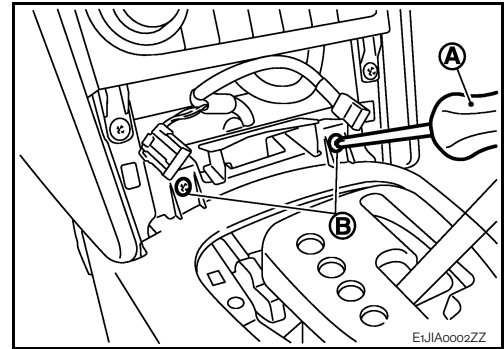

8. Remove lower instrument panel covers. (RH / LH)
 - Pull from the rear of lower instrument panel cover to release rear pawls (1) and clips (2), use flat screwdriver or other suitable tool to release upper metal clip (3).
 - Pull backward to release lower instrument panel cover from instrument panel.

CAUTION:

To avoid damaging parts, it is important to take care for removal of this part.

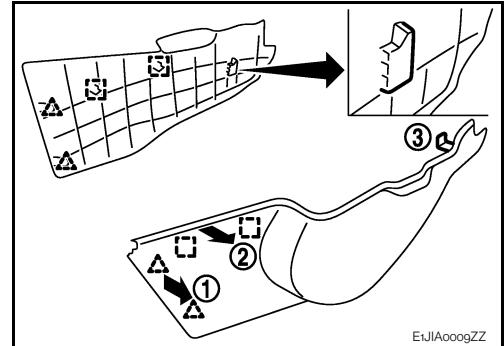

9. Remove hand brake cable adjusting nut (A) to loosen cable sufficiently. Refer to [PB-5, "Exploded View"](#).

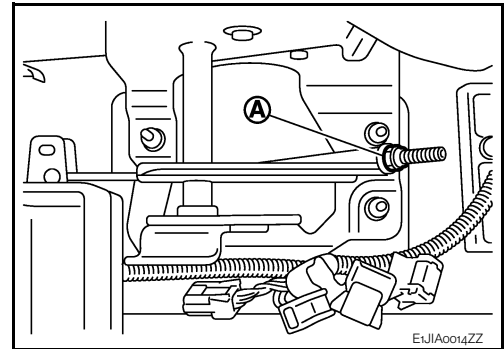

10. Remove center console rear finisher.
 - Pull back release metal clip from center console.
 - Remove inside key antenna and connector (A).
 - Disconnect harness connector fixing clip.
 - Remove key antenna fixing screw (B).

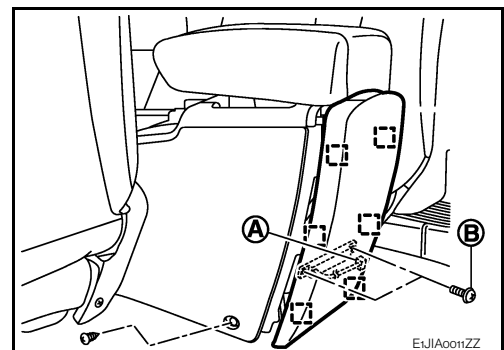

11. Remove center console rear fixing screws, move forward front seats if necessary. For electrical seat refer to [IP-8, "Precaution"](#).
12. Remove center console assembly. Refer to [IP-18, "Exploded View"](#).

CAUTION:
Always move center console with caution to avoid damaging seats, or other part.
13. Remove display unit. Refer to [AV-207, "Exploded View"](#).

INSTRUMENT PANEL ASSEMBLY

< ON-VEHICLE REPAIR >

14. Remove cluster lid C.
- Using flat screwdriver or other suitable tool, and shop cloth, release front metal clip.
 - Pull back cluster lid C from lower to upper part.
 - Disconnect harness connectors.
 - Remove hazard switch. Refer to [EXL-182, "Exploded View"](#).
 - Remove seat belt warning unit. Refer to [SBC-35, "Removal and Installation"](#).
 - Remove center air grille assembly. Refer to [VTL-46, "CENTER VENTILATOR GRILLE : Exploded View"](#) (Automatic air conditioner), [VTL-97, "CENTER VENTILATOR GRILLE : Exploded View"](#) (Manual air conditioner).

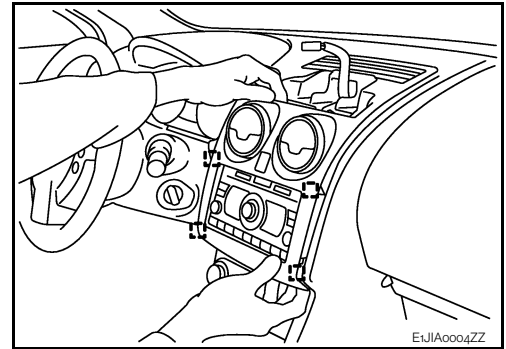

15. Remove AC controller fixing screws (A), then release AC controller from instrument panel.
16. Remove CD changer unit (if equipped).
- Remove fixing screws.
 - Disconnect harness connector.
17. Disconnect inside key antenna connector and clip located under audio unit (if equipped).
18. Remove audio unit (if equipped). Refer to [AV-35, "Exploded View"](#) (without navigation), [AV-206, "Exploded View"](#) (with navigation).
19. Remove front side of body side welt LH. Refer to [INT-14, "Exploded View"](#).
20. Remove front pillar garnish (LH and RH). Refer to [INT-14, "Removal and Installation"](#).
21. Remove driver side instrument side finisher.
- Insert a remover tool into lower space.
 - Pull the instrument side finisher crosswise.

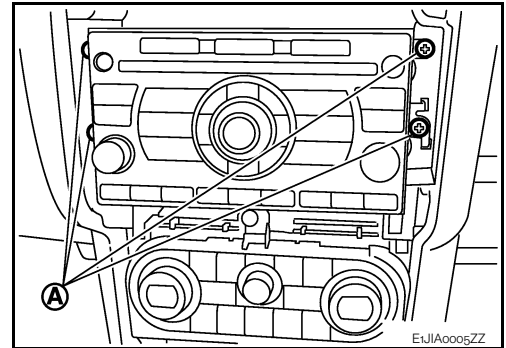

22. Remove lower instrument panel, driver side.
- Remove hood opener (A) mounting bolts. Refer to [DLK-227, "HOOD LOCK CONTROL : Exploded View"](#).
 - Remove fuse box lid (B).
 - Remove data link connector.
 - Pull back lower instrument panel (1), driver side.
 - Disconnect harness connectors.
 - Remove AC sensor.
 - Release data link connector (pawl) then remove it from lower instrument panel, driver side.

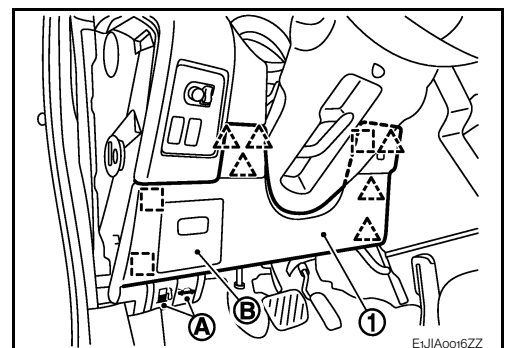
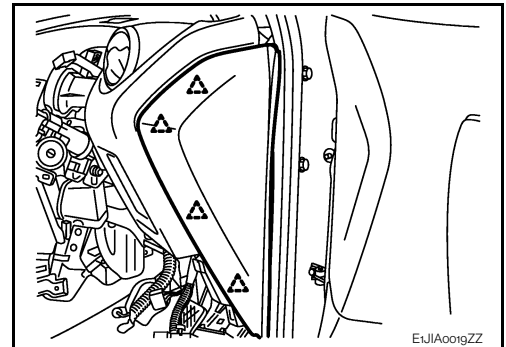

23. Remove steering wheel. Refer to [ST-9, "Removal and Installation"](#).

INSTRUMENT PANEL ASSEMBLY

< ON-VEHICLE REPAIR >

24. Remove steering column covers.
- Release steering column handle.
 - Remove steering column escutcheon (1).
 - Remove steering column front lower cover (2) fixing screw (5), then remove it.
 - Remove steering column front lower protector (3) (if equipped).
 - Pull steering column cover upper (4).
 - Release fixing clip from steering column finisher (6), then remove steering column upper.
 - Disconnect ADP steering switch connector (with automatic drive position).

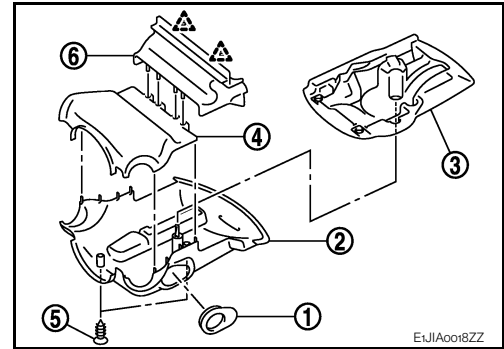

25. Remove spiral cable. Refer to [SR-6, "Removal and Installation"](#).
26. Remove combination switch. Refer to [EXL-178, "Exploded View"](#).
27. Remove paddle ESP and mirror switch LH/RH.

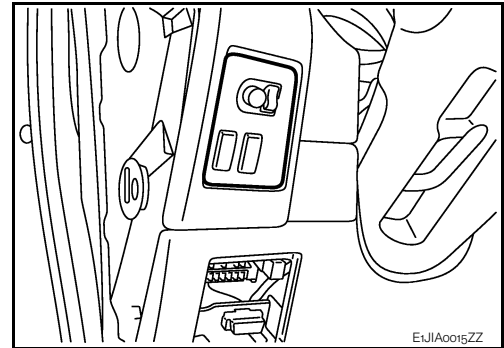

28. Remove cluster lid A.
29. Remove combimeter.
- Remove combimeter fixing screws.
 - Pull combimeter.
 - Disconnect harness connectors.
30. Remove defroster grille LH. Refer to [VTL-49, "SIDE DEFROSTER NOZZLE : Exploded View"](#) (Automatic air conditioner), [VTL-100, "SIDE DEFROSTER NOZZLE : Exploded View"](#) (Manual air conditioner).
- Pull upward, disengage pawls.
 - Disconnect harness connector.
31. Remove defroster grille RH. Refer to [VTL-49, "SIDE DEFROSTER NOZZLE : Exploded View"](#) (Automatic air conditioner), [VTL-100, "SIDE DEFROSTER NOZZLE : Exploded View"](#) (Manual air conditioner).
- Pull upward, disengage pawls.
 - Disconnect harness connector (if equipped).
32. Remove key antenna. Refer to [DLK-272, "INSTRUMENT CENTER : Removal and Installation"](#).
33. Remove front part of body side welt RH. Refer to [INT-14, "Exploded View"](#).
34. Remove front pillar garnish RH. Refer to [INT-14, "Removal and Installation"](#).
35. Remove passenger side instrument side finisher (1).
- Insert a remover tool into lower space.
 - Pull the instrument side finisher crosswise.

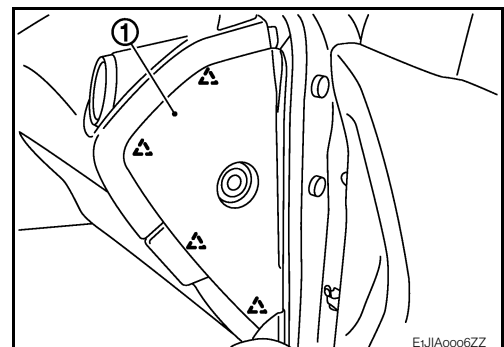

INSTRUMENT PANEL ASSEMBLY

< ON-VEHICLE REPAIR >

36. Remove lower instrument panel passenger side.

- Remove rear fixing clip (A).
- Pull downward to disengage pawls.
- Pull back instrument passenger lower cover (1).

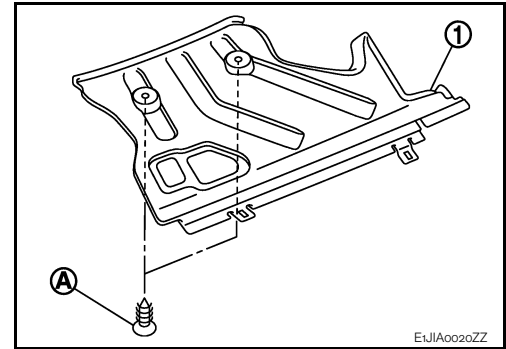

37. Remove glove box assembly.

- Open the glove box.
- Remove fixing screws (A).
- Pull up glove box assembly (1).
- Remove glove box bulb assembly.
- Remove damper pin (2) of outer side.
- Remove glove box door.
- Remove latch.

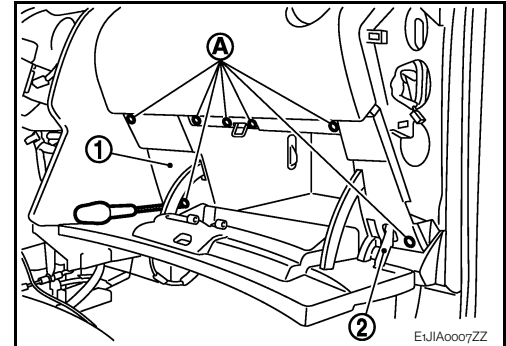

38. Remove tweeter grille RH.

- Disconnect tweeter harness connector.
- Disconnect sun load sensor (if equipped).

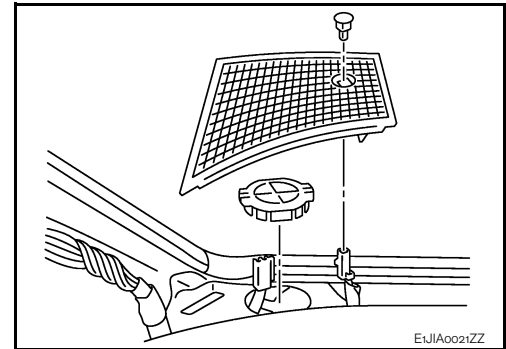

39. Remove lower instrument panel passenger side.

- Remove lower instrument panel passenger mounting screws.
- Disconnect harness connector.
- Pull back lower instrument panel.
- Disconnect harness connector sensor.
- Remove ambient sensor.

40. Disconnect passenger airbag module connector. Refer to [SR-8, "Removal and Installation"](#).

41. Remove passenger airbag module fixing bolt. Refer to [SR-8, "Exploded View"](#).

42. Remove passenger airbag. Refer to [SR-8, "Removal and Installation"](#).

43. Disconnect antenna harness connectors (A), then remove harness clips, from front pillar.

- Release lower passenger side insulator from lower instrument panel.
- Release harness clip from instrument panel.

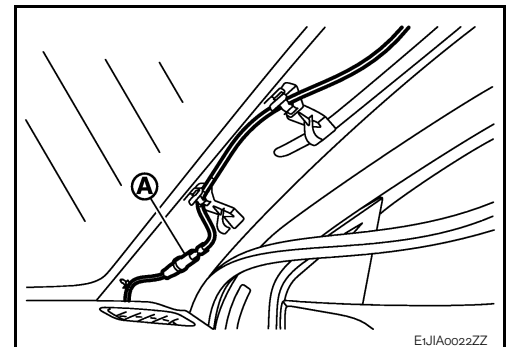

44. Remove instrument panel & pad.

INSTRUMENT PANEL ASSEMBLY

< ON-VEHICLE REPAIR >

- Remove screws (A) and bolts (B), and then remove instrument panel & pad.

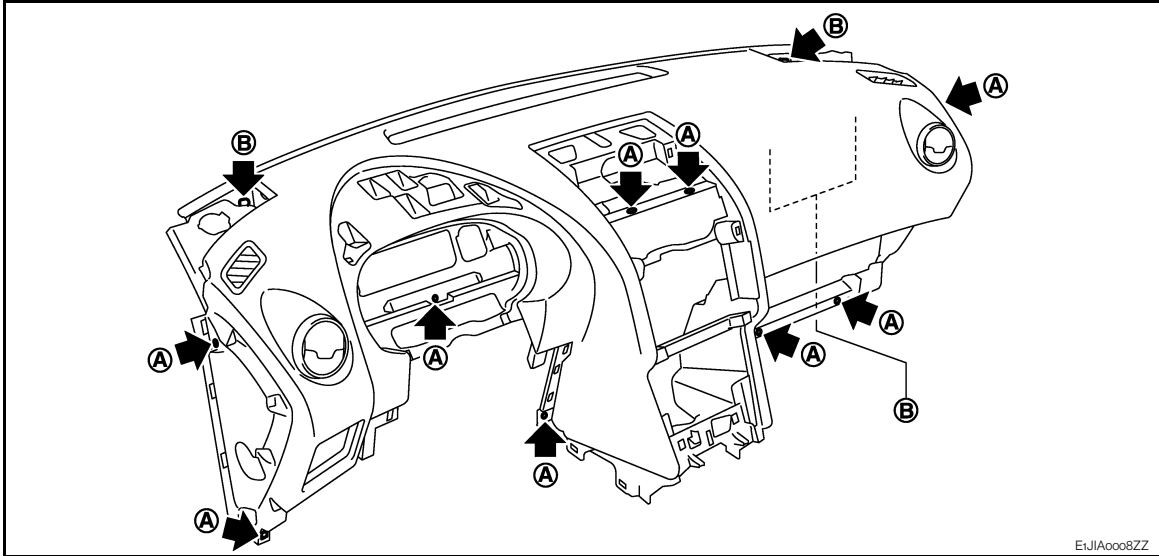

CAUTION:

When removing instrument panel, 2 workers are required so as to prevent it from dropping.

45. Remove the following parts after removing instrument panel & pad.

- Side ventilator grilles
- Center ventilator grilles
- Side defroster grilles
- Side defroster nozzles
- Side ventilator ducts

INSTALLATION

Install in the reverse order of removal.

CENTER CONSOLE ASSEMBLY

< ON-VEHICLE REPAIR >

CENTER CONSOLE ASSEMBLY

Exploded View

INFOID:000000001183496

CENTER CONSOLE

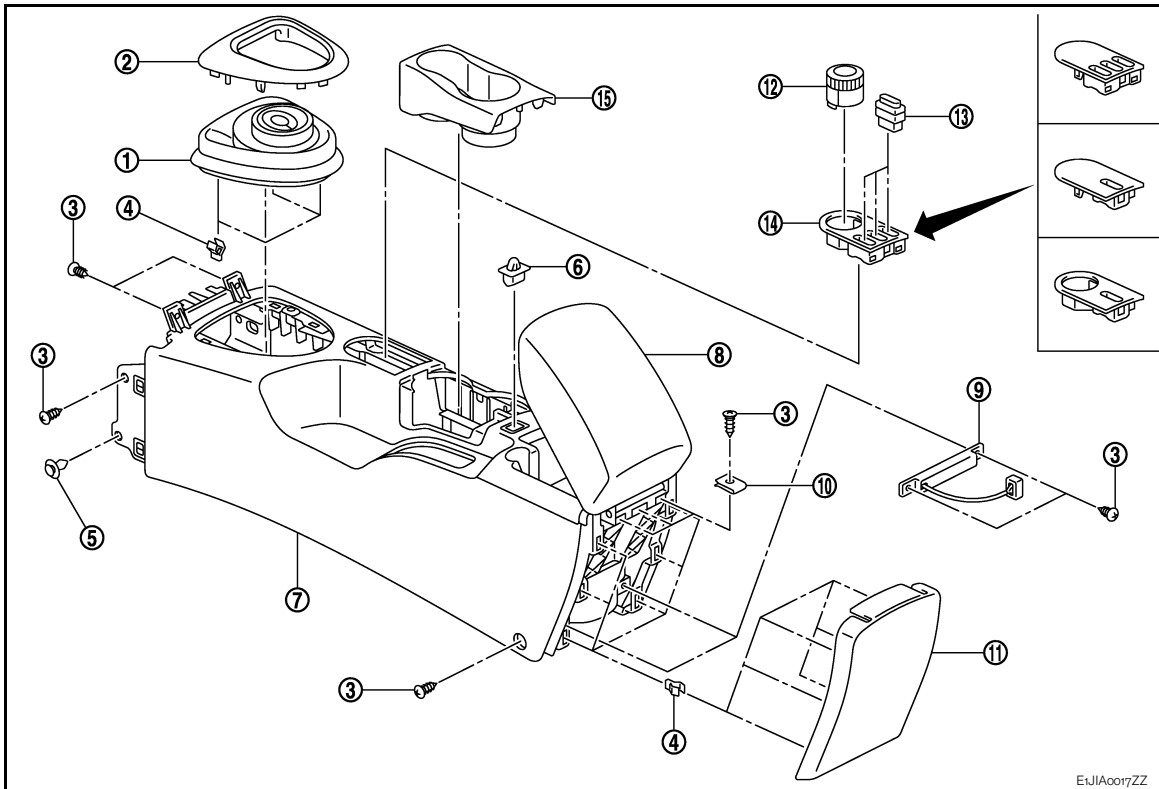

- | | | |
|--|--|---|
| 1. Console finisher assembly (MT models) | 2. Console finisher assembly (AT and CVT models) | 3. Center console fixing screw (LH/RH side) |
| 4. Center console boot assembly fixing clipb (AT only) | 5. Center console fixing clip (LH/RH side) | 6. Center console lid latch assembly |
| 7. Center console assembly | 8. Center console lid | 9. Antenna (if equipped) |
| 10. U-nut | 11. Center console rear finisher assembly | 12. 4WD switch assembly |
| 13. Switch (hazard, door lock, heated seat) | 14. Switch panel | 15. Cup holder |
| Clip | Pawl | Metal clip |

Removal and Installation

INFOID:000000001183497

REMOVAL

1. Put selector lever in drive position. (AT and CVT Models)
2. Remove front console finisher.

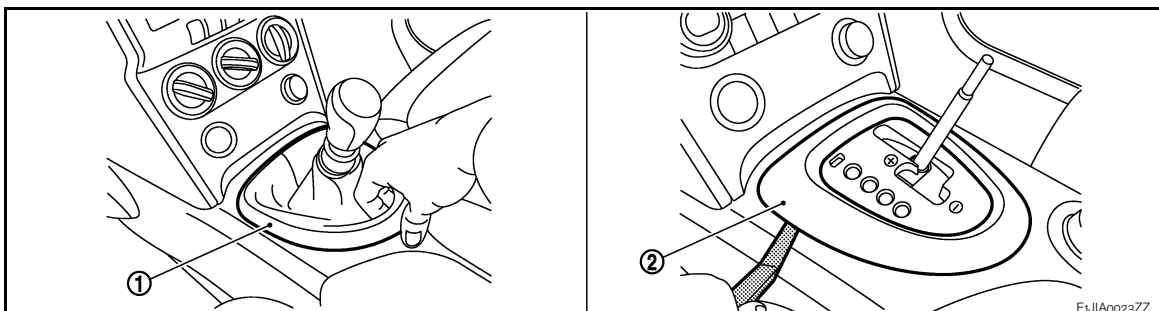

CENTER CONSOLE ASSEMBLY

< ON-VEHICLE REPAIR >

1. Front console finisher (MT models)
2. Front console finisher (AT and CVT models)

- Remove clips from rear of console finisher, and then remove pawl of front. Pull front console finisher upward to disengage from center console.
- Disconnect harness connectors.

3. Remove selector lever knob. (AT and CVT Models)

- Refer to [TM-541, "Removal and Installation"](#).

4. Remove shift lever knob. (MT Models only). Refer to [TM-22, "Exploded View"](#) (5MT), [TM-66, "Exploded View"](#) (6MT: RS6F94R), [TM-124, "Exploded View"](#) (6MT: RS6F52A).

5. Remove Cluster lid D.

- Using clip remover or other suitable tool, release cluster lid metal clips, from lower to upper, from Instrument Panel.
- Release harness connector.

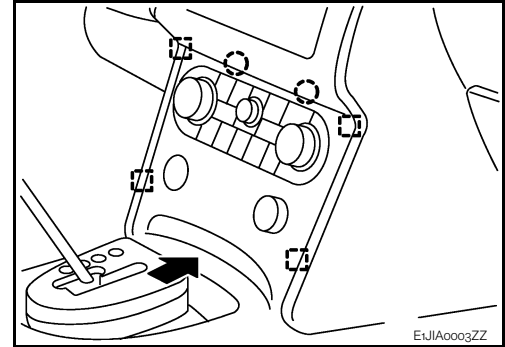
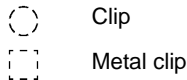

6. Remove screws (B) of center console front side with screw driver (A).

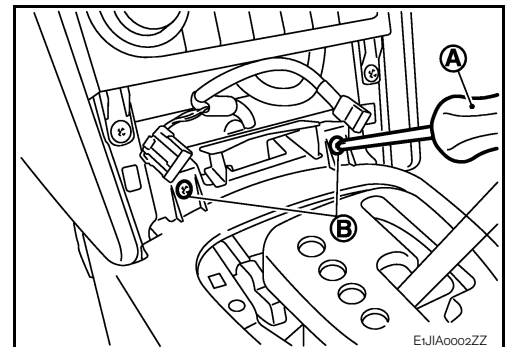

7. Remove lower instrument panel covers. (RH / LH)

- Pull from the rear of lower instrument panel cover to release rear pawls (1) and clips (2), use flat screwdriver or other suitable tool to release upper metal clip (3).
- Pull backward to release lower instrument panel cover from instrument panel.

CAUTION:

To avoid damaging parts, it is important to take care for removal of this part.

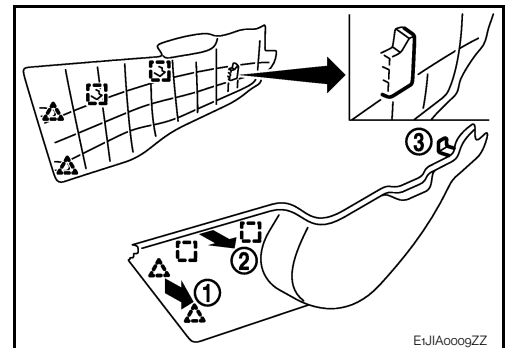

8. Remove center console front fixing screws and clip.
9. Remove cup holder.
 - Pull upward to release cup holder pawls from center console.

CENTER CONSOLE ASSEMBLY

< ON-VEHICLE REPAIR >

10. Remove panel door lock and 4/2WD switch console (A) as shown.
- Push panel switch console assembly from inner center console.
 - Disconnect harness connectors. Refer to [DLK-279, "Exploded View"](#).

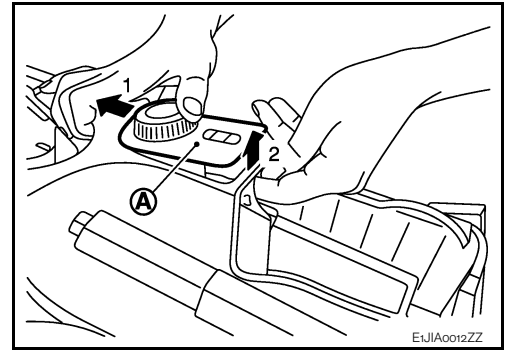

11. Remove hand brake cable adjusting nut (A) to loosen cable sufficiently. Refer to [PB-5, "Exploded View"](#).

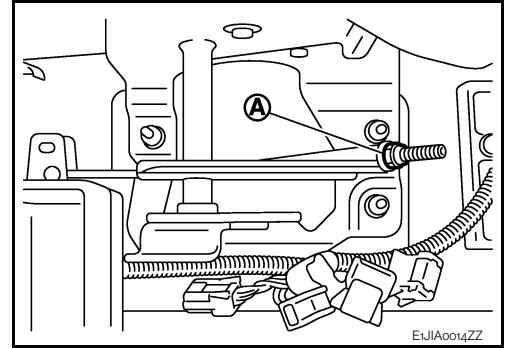

12. Remove center console rear finisher.
- Pull back release metal clip from center console.
 - Remove inside key antenna and connector (A).
 - Disconnect harness connector fixing clip.
 - Remove key antenna fixing screw (B).

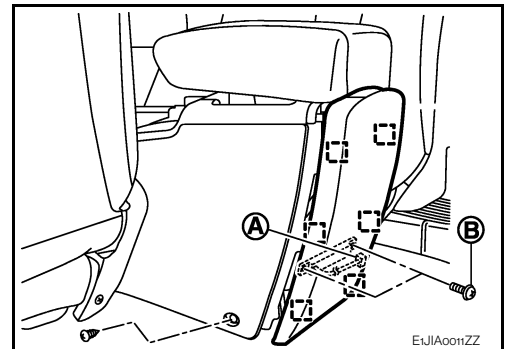

13. Remove center console rear fixing screws, move forward front seats if necessary. For electrical seat refer to [IP-8, "Precaution for Supplemental Restraint System \(SRS\) 'AIR BAG' and 'SEAT BELT PRE-TENSIONER'"](#).
14. Remove center console assembly. Refer to [IP-18, "Exploded View"](#).

CAUTION:

Always move center console with caution to avoid damaging seats, or other part.

INSTALLATION

Install in the reverse order of removal.

Disassembly and Assembly

INFOID:000000001183498

Disassembly

1. Pull upwards and then remove console rear finisher assembly.
2. Remove GPS antenna and connector (models with Navigation). Refer to [AV-42, "Harness Layout"](#).
3. Remove cup holder.

CENTER CONSOLE ASSEMBLY

< ON-VEHICLE REPAIR >

4. Remove 4WD switch assembly and switches, then disconnect connector (A) and remove switch panel.

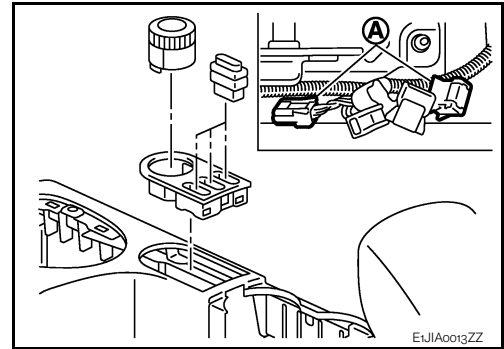

5. Remove console mask.
6. Remove console lid.
7. Remove metal clip and remove console rear finisher.

Assembly

Assemble in the reverse order of disassembly.

A

B

C

D

E

F

G

H

I

IP

K

L

M

N

O

P